

Technical drawing of a boat hull cross-section. The drawing shows the internal structure with various dimensions and labels:

- Dimensions:**
 - 5: Thickness of the top deck.
 - 10: Thickness of the side panel.
 - 20: Thickness of the bottom panel.
 - 150: Height of the main hull structure.
 - 4: Thickness of the bottom panel at the stern.
 - 4: Thickness of the bottom panel at the stern (repeated).
- Labels:**
 - OPASNICE: Label pointing to the side panel.
 - OBŠÍVKA: Label pointing to the bottom panel.
 - PALUBA: Label pointing to the top deck.

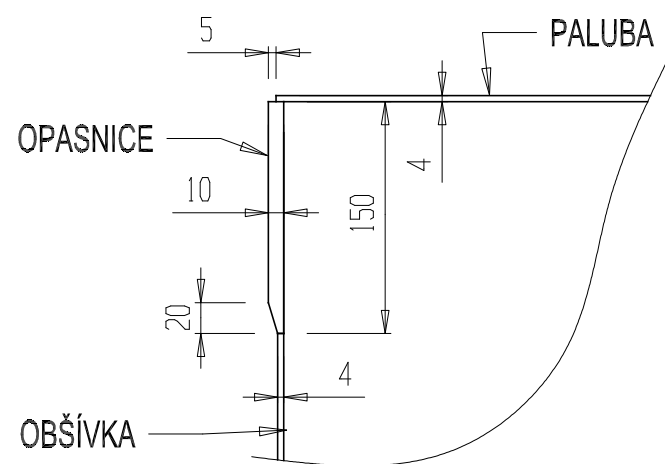

Technical drawing of a corner detail. Labels include: OBŠÍVKA (cladding), OUTOR (outlet), and DNO (bottom). Dimensions shown are 4, 6, 70, and 4.

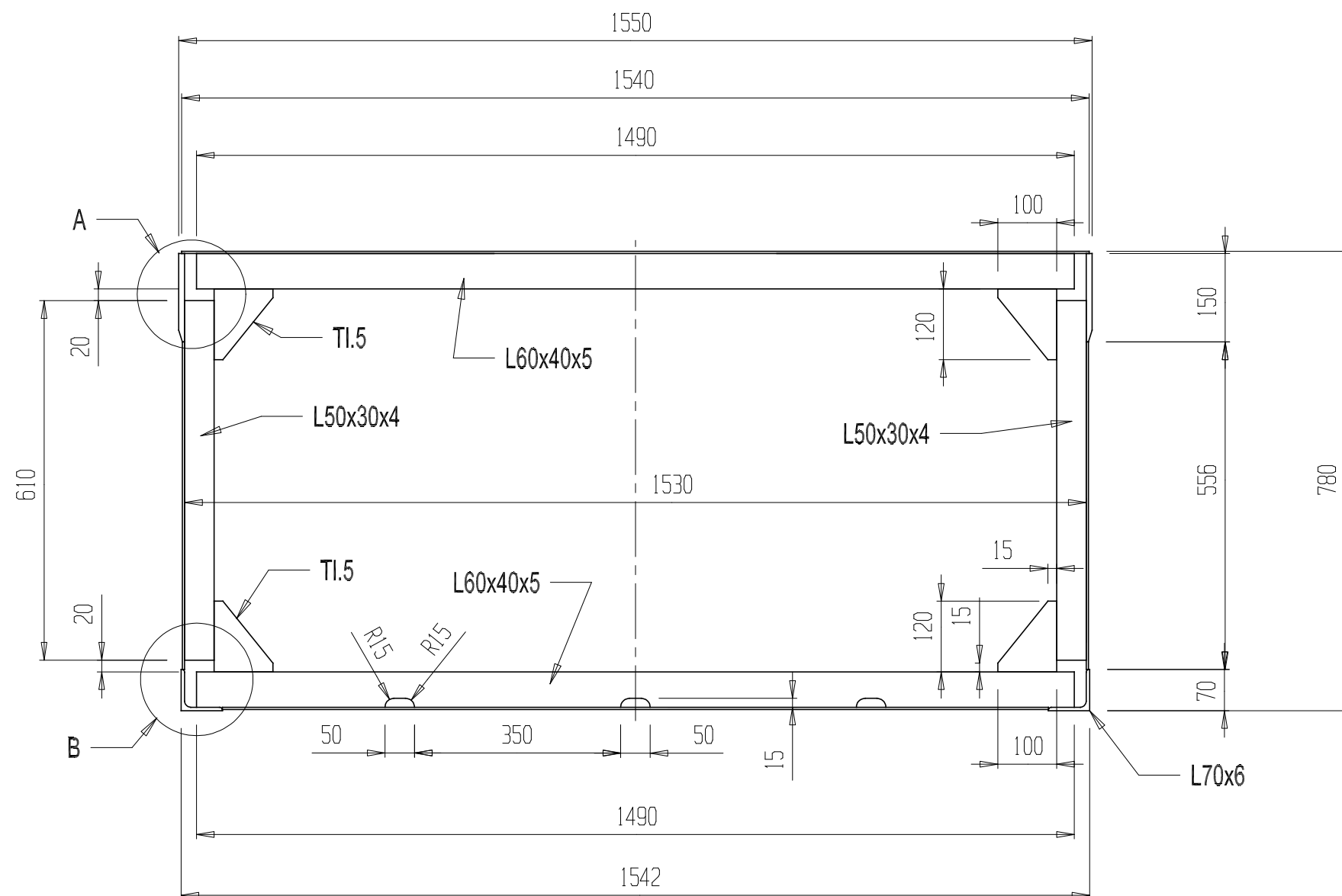
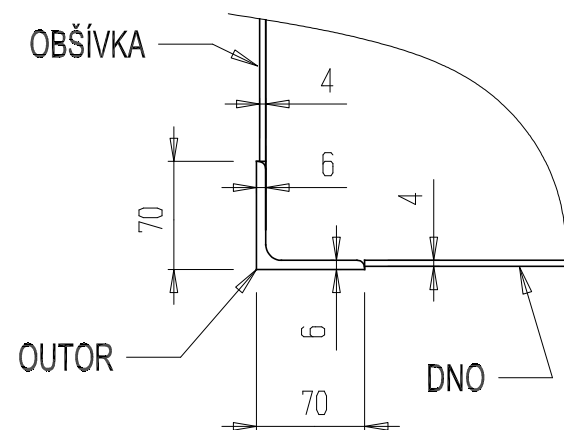

| | | | | | |
|------------------------|----------------------------------|-------------------|--------|------------------------|----------------|
| Měřítka: 1 : 10 | Kreslil: Ing. František Štefunka | Datum: 18.10.2019 | | Typ: plovoucí zařízení | celk. hmot: kg |
| | | Stavba: | ZMĚNA: | a) | e) |
| | Schválil: Jaroslav Jiráň | | | b) | f) |
| | | | | c) | g) |
| | Molo Bystrc | d) | | h) | |

| | | |
|-----------------------|----------------|------------------------|
| JESKO CZ Pardubice | Název: | MB-1-04-00 listů: 1 |
| | Žebro normální | |